

# PEAKCOLD

— P L U S + —

## 2 DOOR DISPLAY COOLER

P-IM43MR2-W

Energy efficient, eco-friendly HC refrigerant with low charge, spark-free components, and the lowest utility costs in its category.



### KEY FEATURES

- **Eco-Friendly Refrigerant**  
Environmentally friendly hydrocarbon refrigerant has low Global Warming Potential (GWP). Meets all USA & California refrigerant & energy standards.
- **Electronic Temperature Controller**  
refrigeration performance through precision temperature control, and intelligent control for defrost cycle, compressor & other component functions.
- **High Power Reliable Refrigeration System**  
Fast pull down, optimal internal air circulation and reliable refrigeration, maintaining colder temperatures for food preservation.
- **Newly Designed Condenser**  
New condenser featuring a joints reduction down to zero increasing long term refrigeration reliability and safeguarding against any system leaks.
- **Standard LED Lighting System**  
Ultra-bright low energy interior LED illumination system provides optimal merchandise display visibility. Low profile, door mounted, clip-in LED design.

### ROCK SOLID

## WARRANTY

No Headaches  
No Registration Required  
For PeakCold Plus Line

**PEAKCOLD**  
— PLUS + —

**5 YEAR ON COMPRESSORS**

**3 YEAR ON PARTS**

**3 YEAR ON LABOR**



**DOE**

### PRODUCT VIEWS

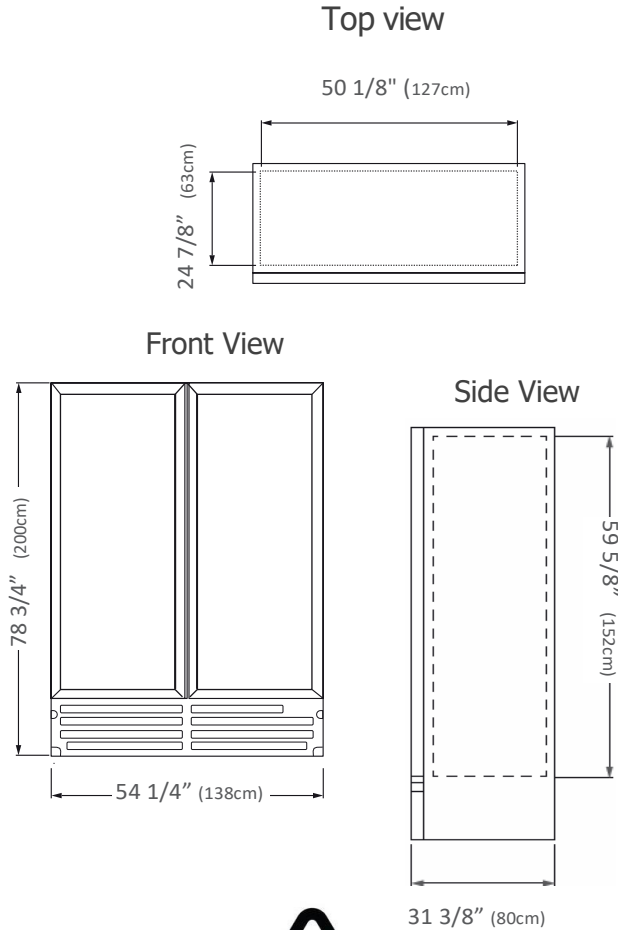

*This equipment is intended for the storage and display of bottled or canned products. This display refrigerator is not for the display of potentially hazardous foods.*

### TECHNICAL SPECIFICATIONS

#### Exterior Dimensions

H: 78 3/4" 200 cm  
 W: 54 1/4" 138 cm  
 D: 31 3/8" 80 cm

#### Interior Dimensions

H: 59 5/8" 152 cm  
 W: 50 1/8" 127 cm  
 D: 24 7/8" 63 cm

#### Usable Interior Capacity

H: 52 1/8" 132 cm  
 W: 47 3/8" 120 cm  
 D: 19 1/8" 49 cm

#### Usable Volume

41.7 ft<sup>3</sup>  
 1180 lts

#### Doors

2

#### Door construction

V7 Plastic frame

#### Shelves

10

#### Shelves Size

W: 24 1/4" 62 cm  
 D: 19 3/4" 50 cm

**External Material** Pre-painted steel

**Internal Material** Pre-painted steel

### REFRIGERATION PERFORMANCE DATA

#### Refrigerant

R290 3.4 Oz (0.095 kg)

#### Energy Consumption

3.290 kWh/24h

#### Compressor Power

1/2+ HP

#### Condenser

Finless (low maintenance)

#### Thermostat setting default

Cut-Out  
 32°F [0°C]

Cut-In  
 44.6°F [7°C]

### ELECTRICAL DATA

#### Power supply

115V/60 Hz

#### AMPS

8.7 A

#### Lighting

205.2 Lux Output  
 18 modules  
 8 LED per module

#### Plug Type

NEMA 5-15P

#### Controller

ETC1H

#### Cord length

128" [327 cm]

- Warranties are not supported outside the continental United States
- All warranties valid from date of purchase and are not transferable to other parties.
- Warranties do not cover the loss of product or income due to equipment malfunction.
- Placing the equipment outdoors, using it to store hazardous materials or modifying the equipment in any way voids all warranties.