

PEAKCOLD

— P L U S + —

2 DOOR DISPLAY COOLER

P-IM43MR2-B

Energy efficient, eco-friendly HC refrigerant with low charge, spark-free components, and the lowest utility costs in its category.



KEY FEATURES

- **Eco-Friendly Refrigerant**
Environmentally friendly hydrocarbon refrigerant has low Global Warming Potential (GWP). Meets all USA & California refrigerant & energy standards.
- **Electronic Temperature Controller**
refrigeration performance through precision temperature control, and intelligent control for defrost cycle, compressor & other component functions.
- **High Power Reliable Refrigeration System**
Fast pull down, optimal internal air circulation and reliable refrigeration, maintaining colder temperatures for food preservation.
- **Newly Designed Condenser**
New condenser featuring a joints reduction down to zero increasing long term refrigeration reliability and safeguarding against any system leaks.
- **Standard LED Lighting System**
Ultra-bright low energy interior LED illumination system provides optimal merchandise display visibility. Low profile, door mounted, clip-in LED design.

ROCK SOLID

WARRANTY

No Headaches
No Registration Required
For PeakCold Plus Line

PEAKCOLD
— PLUS + —

5 YEAR ON COMPRESSORS

3 YEAR ON PARTS

3 YEAR ON LABOR



DOE

PRODUCT VIEWS

Top view

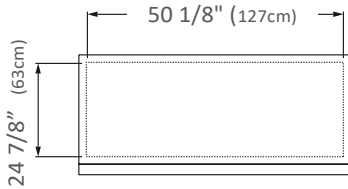

Front View

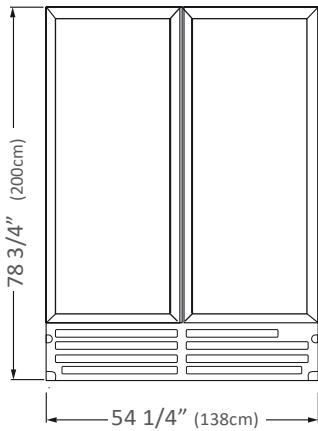

Side View

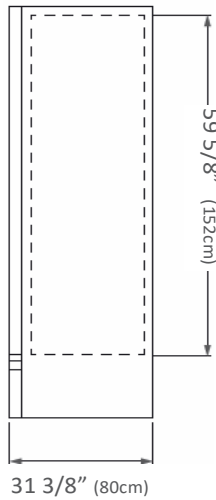

This equipment is intended for the storage and display of bottled or canned products. This display refrigerator is not for the display of potentially hazardous foods.

TECHNICAL SPECIFICATIONS

Exterior Dimensions

H:	78 3/4"	200 cm
W:	54 1/4"	138 cm
D:	31 3/8"	80 cm

Interior Dimensions

H:	59 5/8"	152 cm
W:	50 1/8"	127 cm
D:	24 7/8"	63 cm

Usable Interior Capacity

H:	52 1/8"	132 cm
W:	47 3/8"	120 cm
D:	19 1/8"	49 cm

Usable Volume

41.7 ft ³
1180 lts

Doors

2

Door construction

V7 Plastic frame

Shelves

10

Shelves Size

W:	24 1/4"	62 cm
D:	19 3/4"	50 cm

External Material Pre-painted steel

Internal Material Pre-painted steel

REFRIGERATION PERFORMANCE DATA

Refrigerant

R290 3.4 Oz (0.095 kg)

Energy Consumption

3.290 kWh/24h

Compressor Power

1/2+ HP

Condenser

Finless (low maintenance)

Thermostat setting default

Cut-Out
32°F (0°C)

Cut-In
44.6°F (7°C)

ELECTRICAL DATA

Power supply

115V/60 Hz

AMPS

8.7 A

Lighting

205.2 Lux Output
18 modules
8 LED per module

Plug Type

NEMA 5-15P

Controller

ETC1H

Cord length

128" (327 cm)

- Warranties are not supported outside the continental United States
- All warranties valid from date of purchase and are not transferable to other parties.
- Warranties do not cover the loss of product or income due to equipment malfunction.
- Placing the equipment outdoors, using it to store hazardous materials or modifying the equipment in any way voids all warranties.